

Notes

- Do not scale from this drawing.
- This drawing is based on TOPO Drawing and OS Map X-CSTFLH1240-TOPO, X-CSTFLH1240-OS

Legend

- CH1 - Chainage String 1 along road marking
- CH2 - Chainage String 2 along road marking
- CH3 - Chainage String 3 along road marking
- CH4 - Chainage String 4 along road marking
- CH5 - Chainage String 5 along road marking
- CH6 - Chainage String 6 along road marking
- G - Existing gully
- G - Proposed new gully
- G - Existing Drainage Gully Requires adjustment
- ← - Approximate position of existing drainage pipe and Direction of Flow.
- /■ - Location of manhole and Catch Pit.
- - Further CCTV Investigation is recommended
- - Proposed 225mm Pipe Extension - Length 70m

For continuation please refer above
For continuation please refer below

2 0 5 10
Metres

Rev	Date	Description	Dm	Chk	App
A	24/01/2024	INITIAL ISSUE	BP	JK	RB

This drawing has been specifically prepared to meet the requirements of the named client and may contain design and innovative features which differ from conventional design standards.

Conway House, Vestry Road, Sevenoaks, Kent TN14 5EL
Tel: 01732 600 700
Email: info@conway.co.uk

Client

Project

A20 SIDCUP BY-PASS ROAD
SWANLEY PETROL STATION

Drawing Title

A20 DRAINAGE IMPROVEMENTS
EXISTING AND PROPOSED DRAINAGE
SHEET 1 OF 3

Design Stage

DETAILED DESIGN

Drawing Status

FOR INFORMATION

Drawn	Designed	Date	Scale	Size
BP	JK	24/01/2024	1:200	A1

Drawing No. CSTFLH1240-001-500-001

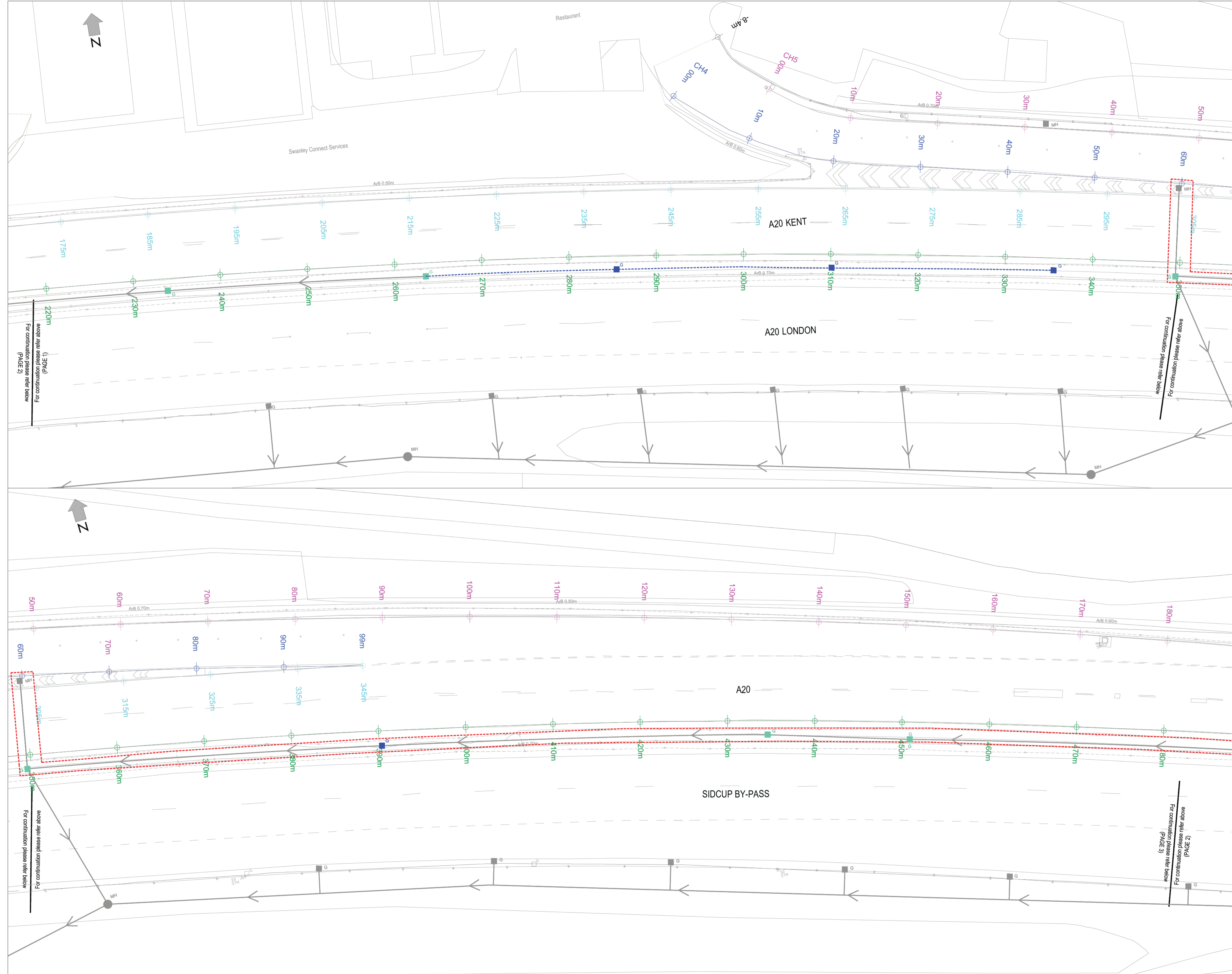

Notes

- Do not scale from this drawing.
- This drawing is based on TOPO Drawing and OS Map X-CSTFLH1240-TOPO, X-CSTFLH1240-OS

Legend

- CH1 - Chainage String 1 along road marking
- CH2 - Chainage String 2 along road marking
- CH3 - Chainage String 3 along road marking
- CH4 - Chainage String 4 along road marking
- CH5 - Chainage String 5 along road marking
- CH6 - Chainage String 6 along road marking
- G - Existing gully
- G - Proposed new gully
- G - Existing Drainage Gully Requires adjustment
- ← - Approximate position of existing drainage pipe and Direction of Flow.
- / MH - Location of manhole and Catch Pit.
- - - - - Further CCTV Investigation is recommended
- - - - - Proposed 225mm Pipe Extension - Length 70m

Scale: 0 5 10 Meters

Rev	Date	Description	Dm	Chk	App
A	24/01/2024	INITIAL ISSUE	BP	JK	RB

This drawing has been specifically prepared to meet the requirements of the named client and may contain design and innovative features which differ from conventional design standards.

CONWAY
great people : great work

Conway House, Vestry Road, Sevenoaks, Kent TN14 5EL
Tel: 01732 600 700
Email: info@tmcconway.co.uk

Client
Transport for London

Project
A20 SIDCUP BY-PASS ROAD
SWANLEY PETROL STATION

Drawing Title
A20 DRAINAGE IMPROVEMENTS
EXISTING AND PROPOSED DRAINAGE
SHEET 2 OF 3

Design Stage
DETAILED DESIGN

Drawing Status
FOR INFORMATION

Drawn	Designed	Date	Scale	Size
BP	JK	24/01/2024	1:200	A1

Drawing No. CSTFLH1240-001-500-002 **Rev** A

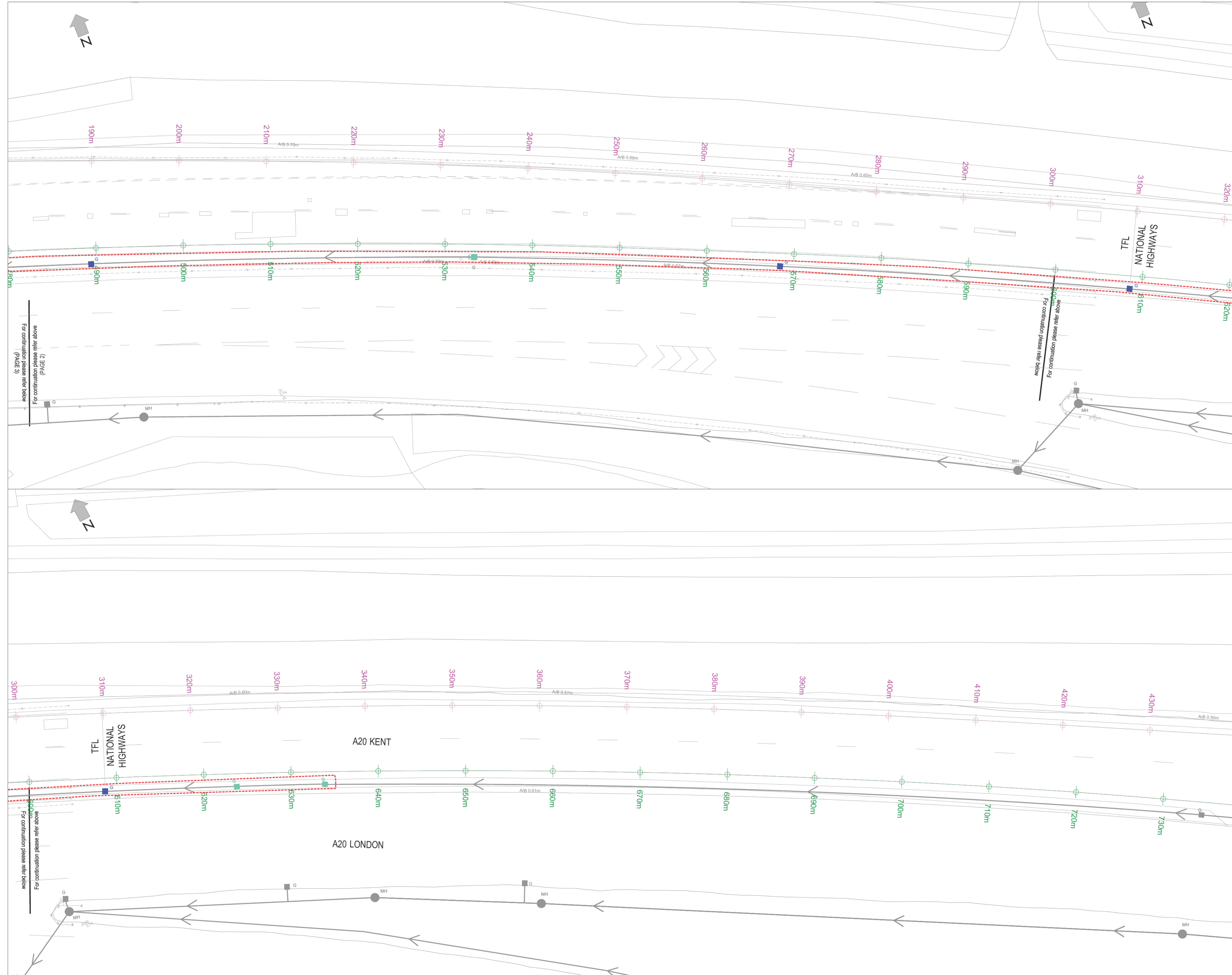

Notes

- Do not scale from this drawing.
- This drawing is based on TOPO Drawing and OS Map X-CSTFLH1240-TOPO, X-CSTFLH1240-OS

Legend

- CH1 - Chainage String 1 along road marking
- CH2 - Chainage String 2 along road marking
- CH3 - Chainage String 3 along road marking
- CH4 - Chainage String 4 along road marking
- CH5 - Chainage String 5 along road marking
- CH6 - Chainage String 6 along road marking
- G - Existing gully
- G - Proposed new gully
- G - Existing Drainage Gully Requires adjustment
- ← - Approximate position of existing drainage pipe and Direction of Flow.
- /■ - Location of manhole and Catch Pit.
- - - - - Further CCTV Investigation is recommended
- - - - - Proposed 225mm Pipe Extension - Length 70m

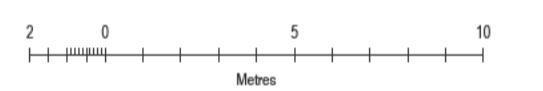

Rev	Date	Description	Dm	Chk	App
A	24/01/2024	INITIAL ISSUE	BP	JK	RB

This drawing has been specifically prepared to meet the requirements of the named client and may contain design and innovative features which differ from conventional design standards.

Conway House, Vestry Road, Sevenoaks, Kent TN14 5EL
Tel: 01732 600 700
Email: info@tmcconway.co.uk

Client

Project
A20 SIDCUP BY-PASS ROAD
SWANLEY PETROL STATION

Drawing Title
A20 DRAINAGE IMPROVEMENTS
EXISTING AND PROPOSED DRAINAGE
SHEET 3 OF 3

Design Stage
DETAILED DESIGN

Drawing Status
FOR INFORMATION

Drawn	Designed	Date	Scale	Size
BP	JK	24/01/2024	1:200	A1
Drawing No.	Rev			
CSTFLH1240-001-500-003	A			